

ASK3199940901- FLEXI VACUUM 800W M-CLASS

PARTS LIST

ITEM	QTY	DESCRIPTION	PART NUMBER
1	1	COMPLETE HEAD-FLEXI VACUUM	ASK3100030550
2	1	COVER+HEAD HANDLE F/BLACK VAC.	ASK4500030079
2.1	1	BLACK CAP FOR VACUUM CLEANER	ASK3100030551
2.2	1	BLACK VACUUM CLEANER HANDLE	ASK4600030310
3	1	CABLE GLAND	ASK4500030138
5	1	ELECTRICAL CABLE-3X1.5 SCHUKO 1.30M	ASK3100030552
6	1	COMPLETE AUXILIARY SCHUKO SOCKET	ASK3100030553
7	1	COVERING CAP-FLEXI VACUUM	ASK3100030558
8	1	CABLE CLEAT	ASK4500030139
9	1	TERMINAL 300-500 3P+NOISE CAPACITOR	ASK3100030555
10	1	COVER-FLEXI VACUUM	ASK3100030559
11	1	SWITCH-FLEXI VACUUM	ASK3100030554
12	1	WARNING RED LIGHT-FLEXI VACUUM	ASK3100030560
13	1	PRESSURE SENSOR-140 MILLIBARS	ASK3100030561
15	1	FILTER HOUSING-MODULE	ASK7800033900
16	1	VACUUM HEAD MOTOR WET STOP-WD	ASK7800033608
17	1	DRY MOTOR SPACER	ASK3100030568
18	1	VACUUM MOTOR 800W P.PRO55 220-240V-50/60Hz	ASK4500030140
19	1	RUBBER RING FOR VACUUM MOTOR	ASK7800033098
20	1	FILTER-MTP/30 65X10 L=495	ASK3100030562
21	1	VAC.MOTOR HOUSING+GASKET+PLATE	ASK4500030074
22	1	PVC HOSE FOR WARNING LIGHT-D.5X3	ASK3100030563
23	1	GASKET H3 F/CARTRIDGE FILTER SUPP.	ASK3100030564
24	1	O-RING-NBR SH70	ASK3100030565
25	1	WARNING LIGHT RUBBER HOLDER	ASK3100030566
26	1	CARTRIDGE FILTER SUPPORT	ASK3100030567
29	1	ONE EAR STEPLESS CLAMP D.5	ASK3100030569

Bona[®]

Description

FLEXI VACUUM 800W M-CLASS - 230 V - 50/60 Hz

Part Number

ASK3199940901

Edition

2.19 - SPARE PARTS

Page

1/3

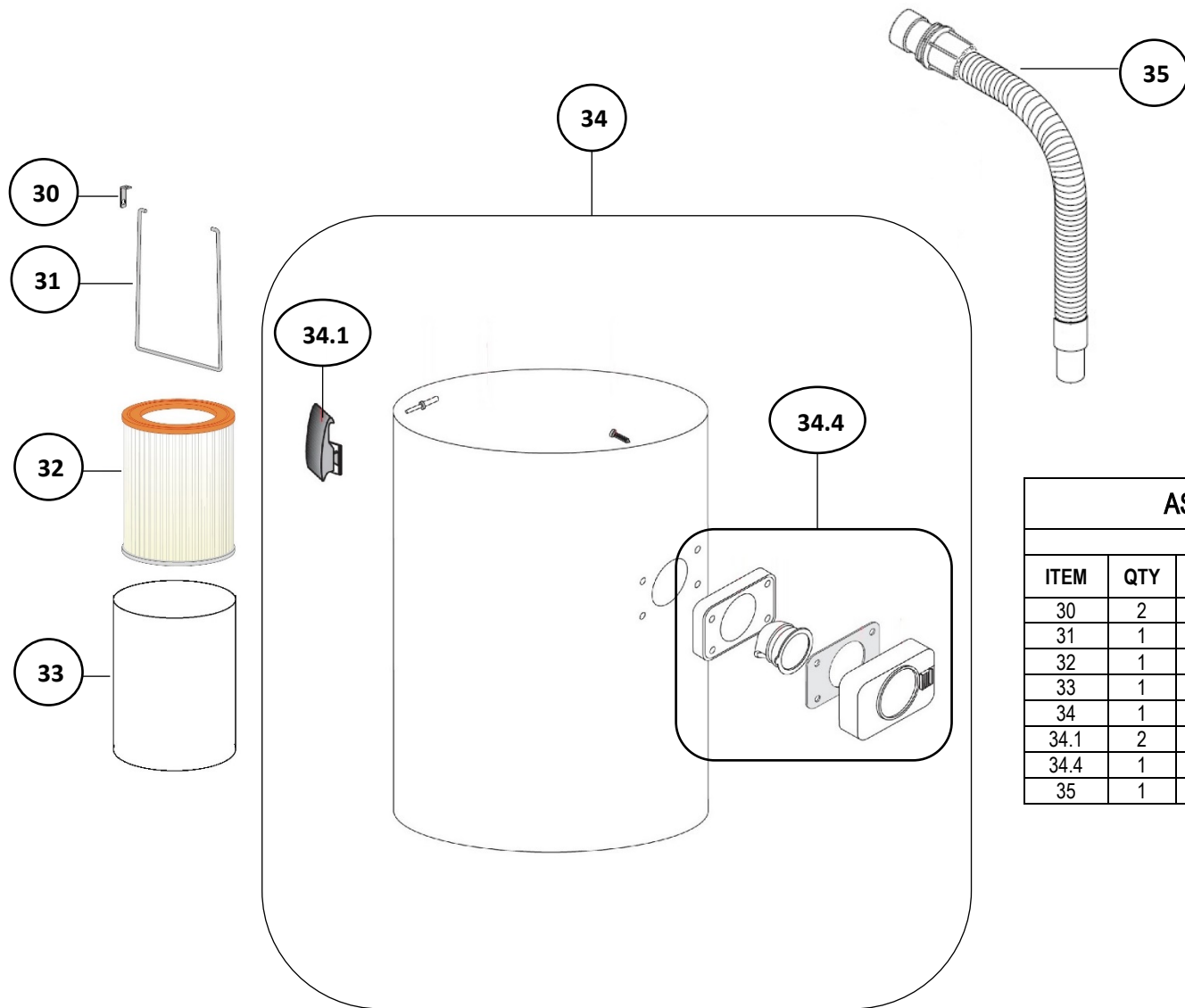

ASK3199940901 – FLEXI VACUUM 800W M-CLASS			
SPARE PARTS			
ITEM	QTY	DESCRIPTION	PART NUMBER
30	2	FILTER-LOCK BRACKET	ASK3100030570
31	1	FILTER-LOCK ROD	ASK3100030571
32	1	POLYESTER FILTER CARTRIDGE	ASK3100030572
33	1	M-CLASS VACUUM PCB PRE-FILTER	ASK3100030584
34	1	COMPLETE PLASTIC SHAFT-FLEXI VACUUM	ASK3100030573
34.1	2	VACUUM SHAFT LOCK HOOK	ASK4500030067
34.4	1	AIR SOCKET F/BLK.VACUUM BASKET	ASK4500030068
35	1	COMPLETE HOSE-L.800-D.38-M CLASS	ASK3400030010

Bona[®]

Description

FLEXI VACUUM 800W M-CLASS - 230 V - 50/60 Hz

Part number

ASK3199940901

Edition

2.19 – SPARE PARTS

Page

2/3

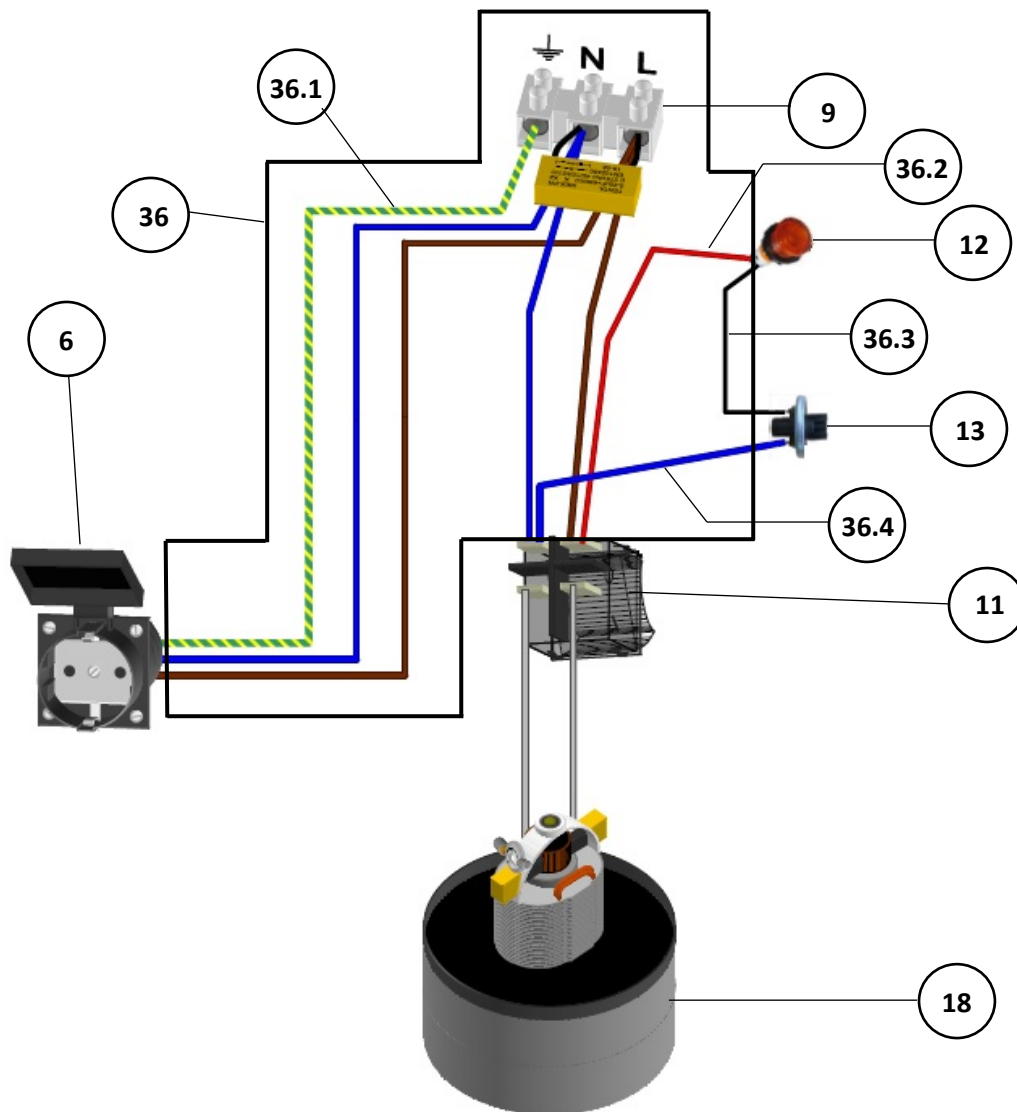

ASK3199940901 – FLEXI VACUUM 800W M-CLASS

SPARE PARTS

ITEM	QTY	DESCRIPTION	PART NUMBER
6	1	COMPLETE AUXILIARY SCHUKO SOCKET	ASK3100030553
11	1	SWITCH-FLEXI VACUUM	ASK3100030554
12	1	WARNING RED LIGHT-FLEXI VACUUM	ASK3100030560
13	1	PRESSURE SENSOR-140 MILLIBARS	ASK3100030561
18	1	VACUUM MOTOR 800W P.PRO55 220-240V-50/60Hz	ASK4500030140
36	1	CABLE KIT FLEXI VACUUM	ASK3199940500
9	1	TERMINAL 300-500 3P+NOISE CAPACITOR	ASK3100030555
36.1	1	CABLE 400-Y/G-STRIP.AUX.SOCK.	ASK3100030576
36.2	1	CABLE 450-RED-DDF-TINN.WAR.RED LIG.	ASK3100030575
36.3	1	CABLE 350-BLACK-FF-TINN.PRES.SEN./WAR.R.LIG.	ASK3100030574
36.4	1	CABLE 200-BLUE-FF-DFF PRESS.SENSOR	ASK3100030556

Bona[®]

Description

FLEXI VACUUM 800W M-CLASS - 230 V - 50/60 Hz

Part number

ASK3199940901

Edition

2.19 – SPARE PARTS

Page

3/3